

PRODUCT CATALOG



WWW.360HUNTINGBLINDS.COM



ABOUT US

At 360 Hunting Blinds we're passionate about whitetail hunting, land management and passing on our hunting heritage to the next generation. That's why we can say our blinds are truly built by hunters for hunters.

Whether you're hunting alone or with a buddy, our goal is to make your hunts as enjoyable and comfortable as possible; because when you're having fun it's easy to put in the time that it takes to put that next big buck down. We can assure you that at 360 Hunting Blinds you will find a well built quality blind that you can be proud of for many years.



360 SERIES



THE SHOOTIN' HOUSE



THE SHANTY HUNTER

OUR PRODUCTS

It all began with the 360 Series which has become our signature blind and is the design that differentiates us from our competitors. Over the years we've evolved to include two other box blinds with unique features for a product line-up with options for nearly any hunter.

360 SERIES

The 360 blinds' spacious 6ft, 6in high interior allows the hunter to stand fully upright, and it's wide enough to comfortably seat two people.

The twelve by eighteen-inch tinted windows feature our state-of-the-art window raising mechanism, a silent, one-handed operation.

Our solid wood frame construction and a seamless acrylic roof are built to provide hunters with many seasons of comfortable, weatherproof hunting.

VISIT OUR WEBSITE TO DOWNLOAD A SETUP ASSEMBLY MANUAL

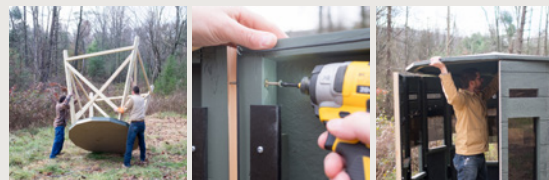

360 PRO

- A:** Integrated ventilation
- B:** Seamless acrylic roof coating
- C:** Peep windows at standing height
- D:** 24x60 inward swinging door
- E:** Tinted rifle and archery windows
- F:** LP Smart Side exterior



- FEATURES INCLUDED**
- 12"x18" tinted gun/crossbow windows
 - 12"x32" Archery windows
 - 18"x12" window in 24"x 60" lockable door
 - 4"x12" peep windows
 - Four, 4x4 pockets for stand posts
 - Padded shooting rails at each window
 - Integrated Ventilation Above Door
 - Carpeted floor & walls up to bottom of windows

- UPGRADE OPTIONS**
- Insulated floor and walls
 - Metal tower stand
 - Wooden tower stand
 - Handicap accessible door
 - Shelf with Cup-holder
 - Hybrid Window w/ Clear & Tinted Plexiglass



FEATURES UPGRADES & FLOOR PLANS

360 PRO

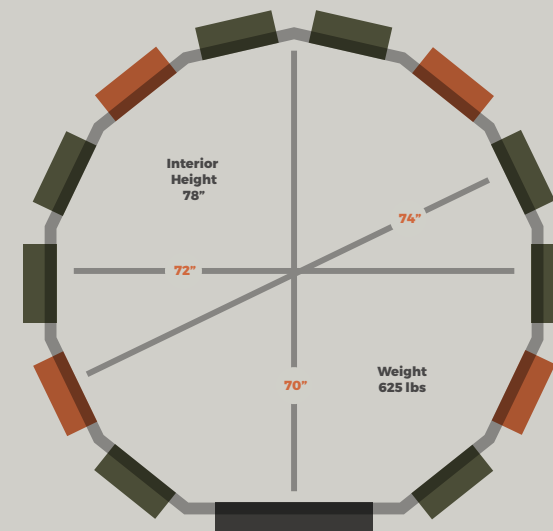

360 PRO XL

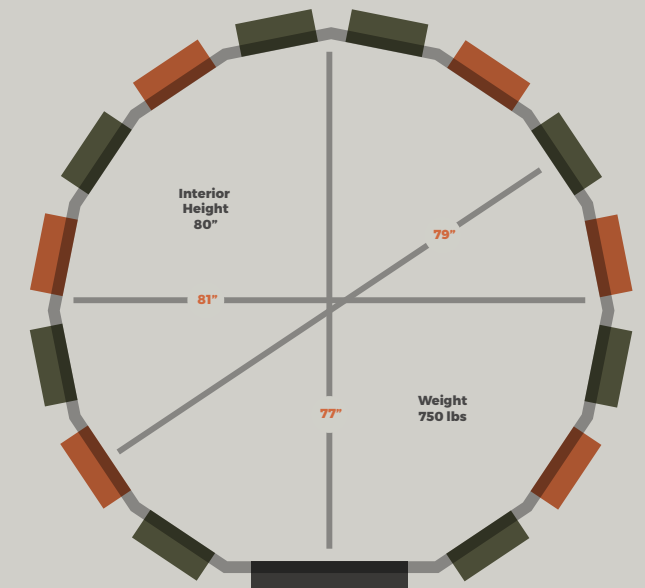

THE SHOOTIN' HOUSE



THE SHOOTIN' HOUSE

The Shootin' House is our angle on a box blind that doesn't compromise the visibility from the corners of the blind.

With the same general dimensions of the 360 Series blinds, but with more space in each corner, this is a great blind for hunters who bring the kids or want to hang out with a buddy.

- A:** Integrated ventilation
- B:** Seamless acrylic roof coating
- C:** Peep windows at standing height
- D:** 24x60 inward swinging door
- E:** Tinted rifle and archery windows
- F:** LP Smart Side exterior



FEATURES INCLUDED

- Three 29"x16" tinted gun/crossbow windows
- Four 12"x32" Archery windows
- One 18"x12" window in 24"x 60" lockable door
- 4"x12" peep windows
- Four, 4x4 pockets for stand posts
- Padded shooting rails at each window
- Integrated Ventilation Above Door
- Carpeted floor & walls up to bottom of windows

UPGRADE OPTIONS

- Insulated floor and walls
- Metal tower stand
- Wooden tower stand
- Handicap accessible door
- Shelf with Cup-holder



If you're in the market for a blind I believe you too will love the endless options that 360 Hunting Blinds offer. As someone who spends countless days in the field I choose 360 Blinds, because it's the best blind on the market!

- Blair Goins - The Rival TV

FEATURES UPGRADES & FLOOR PLAN

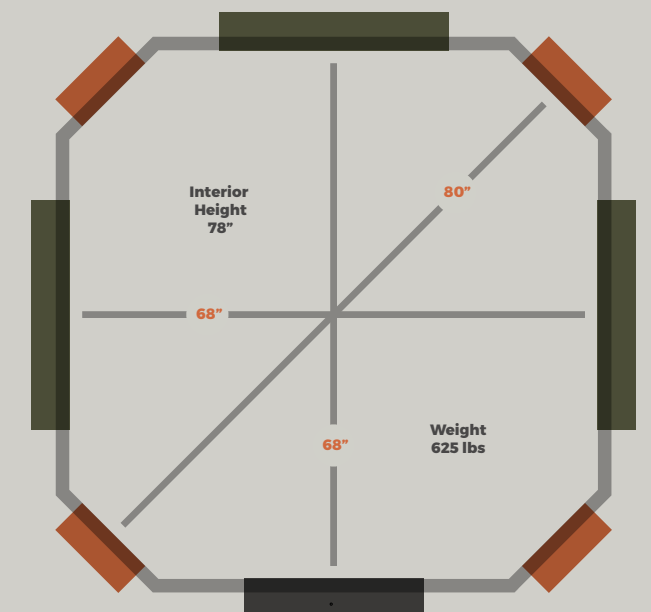

SHANTY HUNTER

The Shanty Hunter embodies the essential blind features that practical, budget conscious hunters demand.

This blind is available at a lower price point but still has the same quality materials and seamless roof found on our other blinds.

While this blind doesn't give you a full 360-degree view, our customers love the additional floor space provided by this design.

If you're looking for a custom blind with room for three or 4 hunters, we can build this design with larger dimensions to fit your needs.

SHANTY HUNTER



- A:** Seamless acrylic roof coating
- B:** 24x60 inward swinging door
- C:** Tinted rifle windows
- D:** LP Smart Side exterior



FEATURES UPGRADES & FLOOR PLAN

FEATURES INCLUDED

- Three 29"x16" tinted gun/crossbow windows
- One 18"x12" window in 24"x 60" lockable door
- Four, 4x4 pockets for stand posts
- Padded shooting rails at each window
- Integrated Ventilation Above Door

UPGRADE OPTIONS

- Insulated floor and walls
- Metal tower stand
- Wooden tower stand
- Handicap accessible door
- Carpeted floor & walls up to bottom of windows

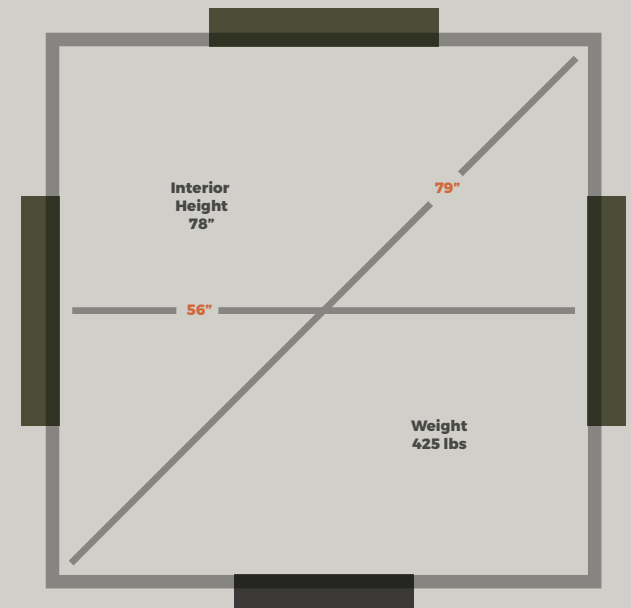

The tinted windows in the 360 Hunting Blind allow freedom of movement inside the blind without deer being able to spot me.

- Ed W. Memphis MO



The amazing 360 degree view from inside a 360 hunting blind is something one must experience for themselves to fully appreciate.

TOWER STANDS

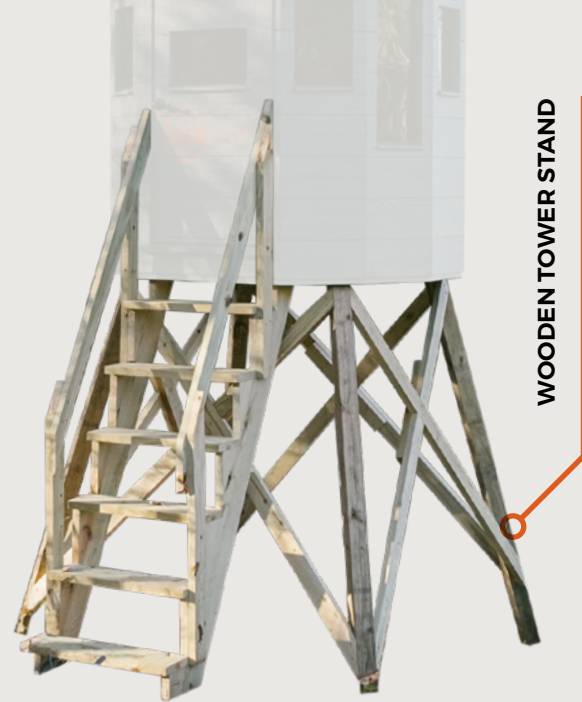

WOODEN TOWER STAND



METAL TOWER STAND



CUSTOM TOWER STAND

We offer tower stand kits available for your 360 Hunting Blind in both wood and metal.

Our wooden stand is a sturdy, pressure treated design that blends well into the environment.

The metal tower stand is powder coated for durability and many years of maintenance free use.

Our tower kits ship with all the hardware you need to elevate and secure your blind.

Reach for the sky with a custom tower stand suited for your needs.

We are able to build nearly any stand in any place. So if you're dreaming of a 20ft platform on top of a mountain, we can make that happen for you!

STAND SIZES

| WOOD | METAL |
|------|-------|
| 8ft | 8ft |
| 12ft | 12ft |
| 16ft | 16ft |

WHY CHOOSE 360 HUNTING BLINDS?

Our mission is to build the best wooden blinds on the market and that informs every decision from design to construction.

Our build process happens inside a modern facility with the tools and the space to enable our skilled craftsmen to do their jobs well so your blinds will last for many years to come



Quality Materials

We believe a design is only as good as the products used to make it.



Experienced Craftsman

We've been building things for over a decade and bring a highly developed skill-set to our craft.



Innovative Builds

Challenging constraints push us to creative solutions that result in a product we believe is built to the highest standards on the market.



Structural Integrity

Our designs are built to withstand incredible pressures in key stress points.



Strong Floor

The floor in our hunting blind is designed to last for many hunting seasons supporting the weight of multiple hunters with gear.



Innovative Builds

Every piece is carefully cut and assembled for a tight fit.



Seamless Roof

Using market leading commercial roofing materials we build a seamless waterproof roof that will last decades.



Painted Exterior

Prior to packaging and shipping each blind, the walls are painted in a camouflage green to blend into a wooded setting.



Weather Sealed

We use rubber weather stripping on our doors and window sills to ensure that no matter the weather, your 360 Hunting Blind will always be dry inside.



Easy Assembly

Fully complete individual wall panels to allow for quick and easy two-person assembly on-site.

OUR EXTERIOR OF CHOICE

LP® SmartSide® products are not made of wafer, chip or particle board. In fact, LP® engineered wood products are made with our Treated Wood Strand Technology so you can rest assured your hunting blind will provide years of beautiful service!

All LP SmartSide products are treated with a proprietary SmartGuard® process to resist fungal decay and termites in harsh environments. Tested in Hilo, Hawaii, LP SmartSide products continue to resist structural damage, even after years of exposure to thriving termite colonies and excessive moisture!

It takes only one look to notice the rich cedar grain texture and undeniable beauty of LP SmartSide products when compared to typical pine siding. It's a premium choice that gives your hunting blind an attractive custom-built look!

| | LP SmartSide Panel | Untreated Particle Board Waferboard Chipboard |
|------------------------------------|--------------------|---|
| TREATED ORIENTED STRAND TECHNOLOGY | ✓ | NO |
| INDUSTRY-LEADING WARRANTY | ✓ | NO |
| RESISTS FUNGAL ROT AND DECAY | ✓ | NO |
| RESISTS TERMITES | ✓ | NO |
| RESISTS DELAMINATION | ✓ | NO |
| RESIST SPLITTING AND CRACKING | ✓ | NO |
| RESISTS WARPING | ✓ | NO |
| RICH CEDAR GRAIN TEXTURE | ✓ | NO |



WAXES

Special water-resistant waxes coat each strand or fiber of wood for enhanced durability in rainy, humid environments.

RESIN-SATURATED OVERLAY

Offering the final layer of protection against the elements, a resin-saturated overlay resists moisture intrusion while providing a durable base for quality paint adhesion and beauty.

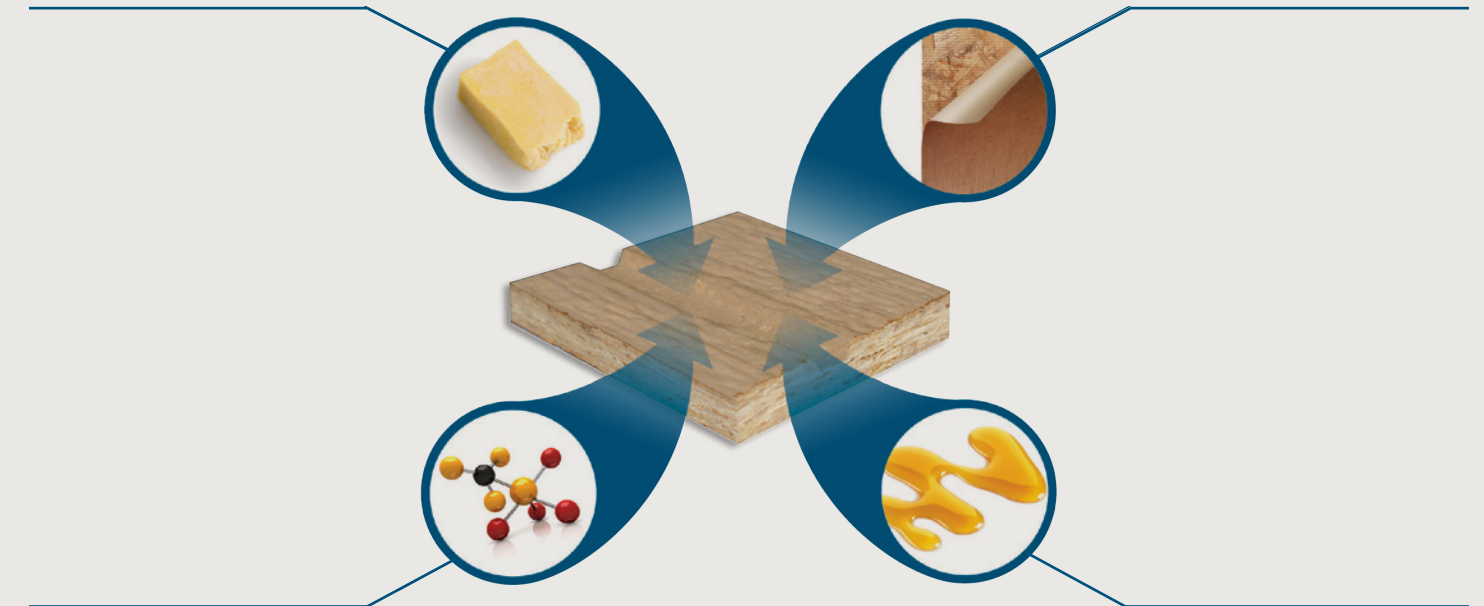

ZINC BORATE

Engineered wood products treated with zinc borate have been proven to effectively resist damage from termites and fungal decay for decades. Safe for children and pets, this naturally occurring additive provides long-lasting performance that preserves the beauty of LP SmartSide Trim and Siding.

ADVANCED BINDERS

LP SmartSide Trim and Siding provide incredible strength to resist impact damage thanks to their industrial-grade binders and resins. You'll have the confidence of knowing that your siding can stand up to everyday airborne debris such as hail and sticks, etc.



HUNTING SMOKEY

When I was blessed to shoot “Smokey” my second 200” whitetail in 2017 it was no coincidence that I did so from a 360 Hunting Blind. I was first introduced to 360 Hunting Blinds at an outdoor show in Ohio a couple of years earlier and was so impressed that my business partner Kevin Boyer and I actually tried to buy the company.

Kevin and I are the owners of Real World Wildlife Products but we are serious deer hunters and land-managers first and foremost. We know what it takes to be



Scan me

SCAN THE BARCODE WITH YOUR SMARTPHONE CAMERA TO GET THE FULL STORY OF THE HUNT

successful and demand the highest quality products for our own hunting. The window system in the 360 hunting blinds is second to none. 360 hunting blinds are also quiet, comfortable and well-built.

While Smokey was the first deer I ever shot from a 360 Hunting Blind, I am confident he won't be the last.

-Don Higgins, Co-owner of Real World Wildlife Products, Whitetail Consultant, Outdoor Writer



HUNTING STORIES & TESTIMONIALS



We purchased our 360 blind this year and placed it in one of our food plots. The very first time we used the blind my son shot this 160 inch buck from 40 yards with his bow. The 360 view is exceptional. The sliding windows are quiet and easier to adjust than our other blinds. Very little heat is needed on cold days. We are very happy with the 360 Blind.

- Greg D. Iowa



I love hunting with my dad out of our 360 Blind. Especially on cold, rainy days like the day I shot this buck.

- Kade W. Downing MO



360 Hunting Blinds are perfect for us younger hunters because we are able to stay warmer which allows us to sit for longer periods of time. Dad and I made some great memories in our 360 Hunting Blind.

Thanks for making an awesome product and helping to make our hunt successful.

Tyler M, Age 12, PA





There are a lot of reasons why I have 360 Hunting Blinds on my own property, but it all starts with the great visibility and fact that there are no blind spots.

If you are looking for a high-quality hunting blind you owe it to yourself to take a close look at 360 Hunting Blinds.

- Don Higgins, Co-owner of
Real World Wildlife Products



WWW.360HUNTINGBLINDS.COM